



# VL-501B-M

3pc-Design Stainless Steel Ball Valve  
Butt-Weld-Ends



DN8 - DN100

- 3pc design
- Manual operated
- Full bore
- Pressure rating **PN 63**
- Length acc. DIN 3202 **S13** / DIN EN 12982-ETE67
- Temperature range -10°C / +200°C
- Anti-blow-out stem

• BW-Ends acc. DIN EN 12627

On request:

- Different sealing materials
- For steam application
- Locking device
- Further options

Standard	
ISO9001	PED
On request	
FDA	EC1935

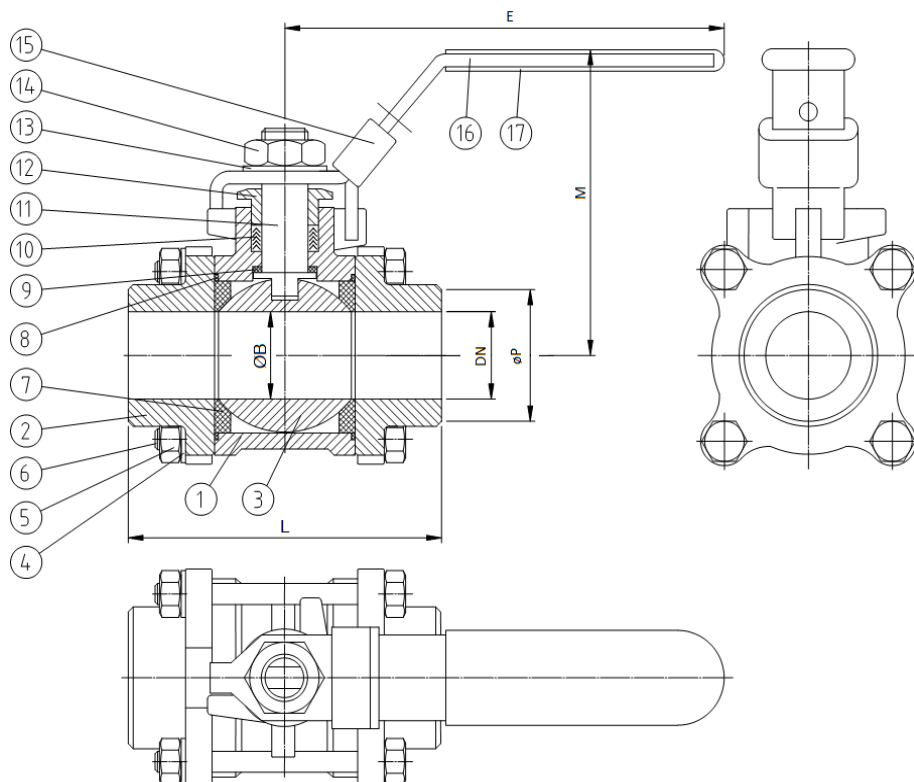

Parts list	Qty.	Material
1 Body	1	1.4408
2 Cap	2	1.4408
3 Ball	1	1.4408
4 Washer	4-12	1.4301
5 Nut	4-12	A2-70
6 Screw / Bolt	4-6	A2-70
7 Ball seat	2	PTFE
8 Body sealing	2	PTFE
9 Thrust washer	1	PTFE
10 Stem packing	1 Set	PTFE
11 Stem	1	1.4401
12 Gland nut	1	1.4301
13 Washer	1	1.4301
14 Nut	1	1.4301
15 Locking device	1	1.4301
16 Hand lever	1	1.4301
17 Sleeve	1	Plastic

<sup>1</sup> optional

DN	Inch	L	ØB	ØP	M	E	[kg]
8	1/4"	65	11,5	12,5	55	97,5	0,4
10	3/8"	70	13	15	55	97,5	0,4
15	1/2"	75	16	18	64	125,5	0,6
20	3/4"	90	20	22	67	125,5	0,9
25	1"	100	25	28	83	143,5	1,3
32	1-1/4"	110	32	35	89	143,5	2
40	1-1/2"	125	38	43	100	203,5	2,8
50	2"	150	51	54	108	203,5	4,4
65	2-1/2"	190	65	69	150	251,5	8,9
80	3"	220	80	84	161	251,5	13,8
100	4"	270	100	104	180	291,5	22,5

Dimensions in mm



Fon +49 7243 5988 - 0

epi@epi.de

www.epi.de